

CERTIFICATE OF LOCATION OF GOVERNMENT CORNER

NORTH QUARTER Corner of Section 19, Township 106, Range 43, 5TH P.M.

STATE OF MINNESOTA, County of MURRAY

At the corner location shown on the sketch:

On 8/31/16 found a pipestone granite rock
DATE

left monument as found, lowered monument, removed monument (explain)

On 8/31/16 placed a 5/8" iron with seal #43844
DATE

SKETCH OF REFERENCE TIES

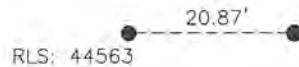
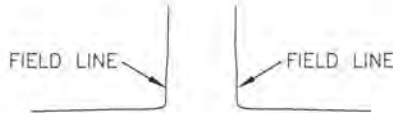

X
X
X

Minnesota State Plane Coordinate
System Murray County Datum
NAD83 (1996)

5/8" rebar with cap RLS: 44563 West 20.87'

N: 147825.247
E: 424370.369

Statement of evidence relative to this corner location is on back of page.

I hereby certify that this document and the data contained herein was prepared by me or under my direct supervision.

SIGNATURE 12/8/16
DATE

Registration No. 43844

- Land Surveyor, Professional Engineer
 County Surveyor, County Engineer

OFFICE OF THE COUNTY RECORDER

County of MURRAY

I hereby certify that this document was filed in the Co. Recorders office at 9:00 A.M. on the 17TH day of FEBRUARY A.D. 20 17

County Recorder Evelyn C. Larson

By _____, Deputy

DOCUMENT NO. _____

Statement of Evidence

In 1866, J.W. Bishop did the original subdivision of the township.

On November 20, 1925, J.W. Woolstencroft set a pipestone granite rock in the old corner.

On March 23, 2006, Ulteig Engineers, Inc., set a 5/8" rebar with cap RLS 44563 in center line of the road and 22'± west of fence to the south.

On August 31, 2016, Bueltel-Moseng Land Surveying dug with a backhoe in the center of the road and in line with fence to the south. We found a pipestone granite rock and wooden stake on the southwest side of stone. We set 5/8" iron with seal #43844 at the surface of road.